

- NOTE:
1. THIS PLAN IS BASED ON A PLAN TITLED EXISTING CONDITIONS PLAN BY BEALS ASSOCIATES, INC. DATED AUGUST 8, 2007.
  2. THIS PLAN IS FOR PERMITTING PURPOSES ONLY AND AS SUCH SHALL NOT BE USED FOR CONSTRUCTION.
  3. NO ADDITIONAL BUILDABLE LOTS MAY BE CREATED FROM THIS PROPERTY.
  4. A PORTION OF THE ZONE A, NO BASE ELEVATION, CROSSES ONTO THE SITE. SEE FEMA MAP 250106 0002 D.
  5. ZONING DISTRICT: OUTLYING RESIDENTIAL & AGRICULTURAL DISTRICT. SCENIC OVERLAY DISTRICT.
  6. THE ANNUAL TOWN MEETING IN MAY 2008 VOTED TO INCLUDE THIS PROPERTY IN THE ELDERSLY HOUSING DISTRICT.
  7. NO ZONE C PROTECTIVE AREA TO AN ORW IS PRESENT ON THIS SITE AS PER MASSGIS MAPPING DATED MARCH 2009.
  8. WETLAND BOUNDARIES SHOWN WERE DEFINED BY AN ORDER OF RESOURCE AREA DELINEATION ISSUED BY THE TOPSFIELD CONSERVATION COMMISSION DECEMBER 20, 2007.
  9. EXISTING TREES TO REMAIN TO MAXIMUM EXTENT POSSIBLE.
  10. PROPOSED PLANTS AS PREPARED IN CONJUNCTION WITH:  
The Green Co., Landscaping & Irrigation Inc. April 2009.

**PLANT SCHEDULE**

KEY	BOTANICAL NAME	COMMON NAME	SIZE	CONDITION
AB	<i>Aster canadensis</i>	White Fl.	8' - 10'	B&B
FC	<i>Morus spp. 'Snowdrift'</i>	Snowdrift Flowering Crab	2.5-3' min. cal.	B&B
JM	<i>Acer palmatum</i>	Japanese Maple	6-10.5' min. cal.	Transplanted on-site
NS	<i>Picea canadensis</i>	Norway Spruce	8' - 10'	B&B
RV	<i>Acer rubrum</i>	Red Maple 'Schubert's Glory'	3-3.5' min. cal.	B&B
SW	<i>Acer saccharinum</i>	Sugar Maple 'Green Mountain'	3-3.5' min. cal.	B&B
TZ	<i>Morus spp. 'Mecourt'</i>	Apple Tree 'Mecourt'	6-10.5' min. cal.	Transplanted on-site
W	<i>Picea glauca</i>	White Spruce	8' - 10'	B&B
WP	<i>Pinus strobus (Eastern)</i>	White Pine	8' - 10'	B&B

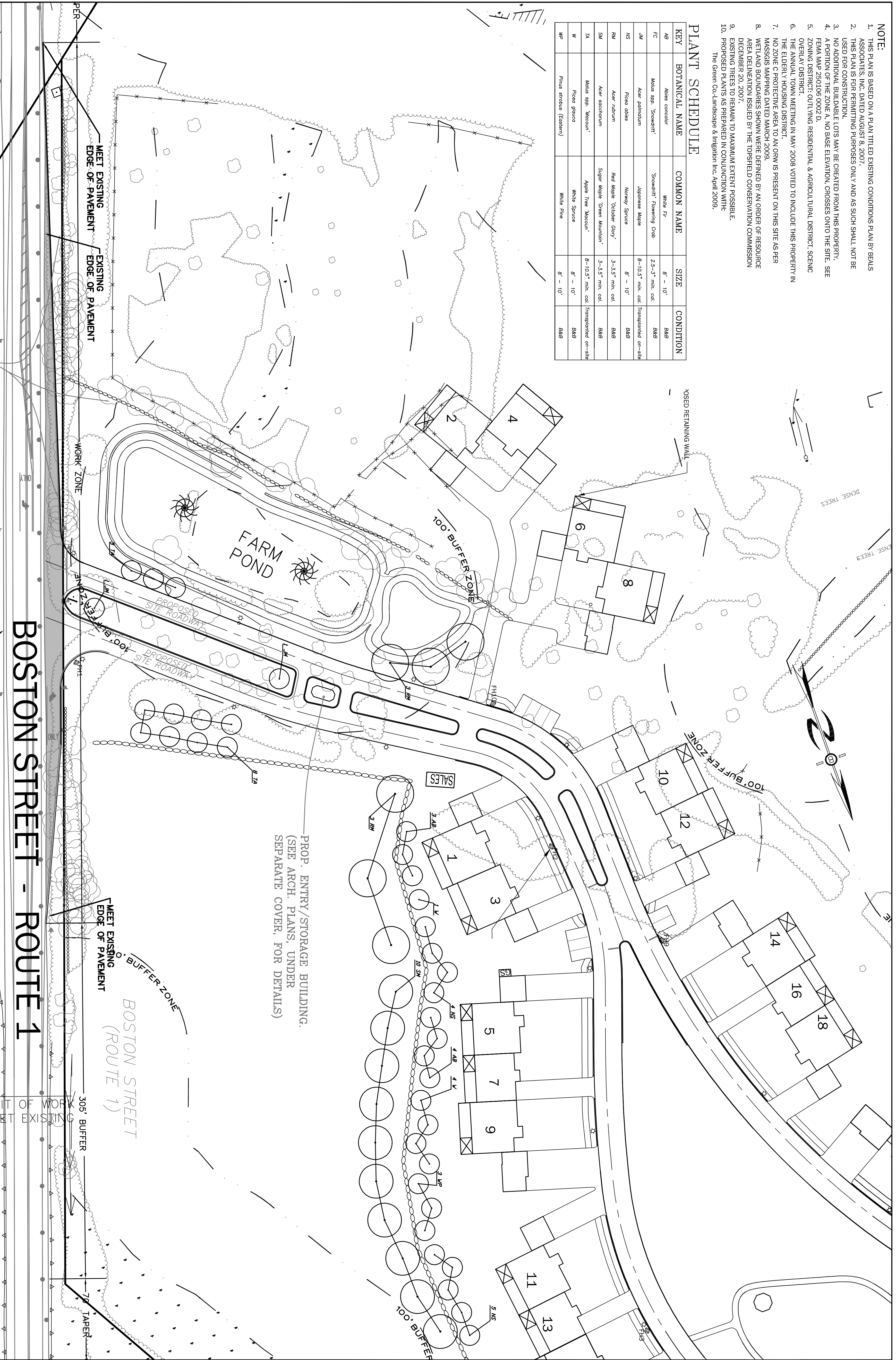

PREPARED FOR:  
**ENGLISH COMMONS, LLC.**  
460 BOSTON STREET  
TOPSFIELD, MA 01983

**BEALS ASSOCIATES INC.**  
2 THIRTEENTH STREET CHARLESTOWN, MA 02129  
PHONE: 617-242-1120 FAX: 617-242-1190

APPROVED:  
TOPSFIELD PLANNING BOARD  
DATE: \_\_\_\_\_

**LEGEND**

- WETLAND FLAG
- STONE WALL
- TREE LINE
- EXISTING CONTOUR - 10'
- EXISTING CONTOUR - 2'
- WETLAND BOUNDARY
- EXISTING PROPERTY LINE
- PROPOSED WATER LINE
- PROPOSED FOUNDATION DRAIN
- PROPOSED STORMWATER LINE
- PROPOSED SEPTIC LINE
- PROPOSED EROSION CONTROL
- SETBACKS
- 100' WETLAND BUFFER ZONE
- PROPOSED STREETLIGHT
- PROPOSED FENCE
- ZONE A BUFFER
- ZONE B BUFFER
- PROPOSED FOUNTAIN
- PROPOSED CATCH BASIN/OCS
- PROPOSED DRAIN MANHOLE
- PROPOSED SEPTIC TANK
- PROPOSED FIRE HYDRANT
- EXISTING TREE
- PROPOSED TREE
- PROPOSED SHRUB

**GRAPHIC SCALE**  
(IN FEET)  
1 inch = 40 ft.

4.	ISSUED FOR APPROVAL	10-06-09
3.	REVISED PER PLANNING BOARD COMMENTS	09-15-09
2.	REVISED FOR MASSHIGHWAY ENTRANCE AND LANDSCAPING	08-25-09
1.	REVISED PER SUBSURFACE DISPOSAL SYSTEM	08-05-09

**LANDSCAPE PLAN**

PLANS FOR  
**ENGLISH COMMONS AT TOPSFIELD**  
12 BOSTON STREET  
TOPSFIELD, MA

PROJECT: C-484.04 DESIGN: TJM SHEET: 20 OF 20  
DATE: AUGUST 13, 2009 CHECKED: CAT/TML  
SCALE: AS NOTED REVISED: GMS

COPYRIGHT © BY BEALS ASSOCIATES INC. - ALL RIGHTS RESERVED  
PATHS:\Data\C-484.04 Topsfield\Autocad\C-484.04 PB-SDS Set (REV 10-6-09).dwg, LANDSCAPE PLAN (END), 10/19/2009 2:47:32 PM

